

Initial Environmental Examination

Document Stage: Draft
Project Number: 53262-001
November 2020

IND: Agartala City Urban Development Project – Upgradation of Major Roads in Agartala City PART D

Prepared by Project Management Unit, Agartala Smart City Limited, Government of Tripura for the Asian Development Bank.

This draft initial environmental examination is a document of the borrower. The views expressed herein do not necessarily represent those of ADB's Board of Directors, Management, or staff, and may be preliminary in nature. Your attention is directed to the “terms of use” section of this website. Your attention is directed to the “terms of use” section of this website.

In preparing any country program or strategy, financing any project, or by making any designation of or reference to a particular territory or geographic area in this document, ADB does not intend to make any judgments as to the legal or other status of any territory or area.

114	Radhachurra	Peltophorum Pterocarpum	90 x 275
115	Radhachurra	Peltophorum Pterocarpum	105 x 150
116	Radhachurra	Peltophorum Pterocarpum	100 x 110
117	Radhachurra	Peltophorum Pterocarpum	90 x 200
118	Radhachurra	Peltophorum Pterocarpum	90 x 450
119	Radhachurra	Peltophorum Pterocarpum	100 x 190
120	Radhachurra	Peltophorum Pterocarpum	90 x 150
121	Radhachurra	Peltophorum Pterocarpum	105 x 125
122	Radhachurra	Peltophorum Pterocarpum	95 x 130 Br-2
123	Radhachurra	Peltophorum Pterocarpum	125 x 100
124	Radhachurra	Peltophorum Pterocarpum	130 x 200
125	Radhachurra	Peltophorum Pterocarpum	140 x 300
126	Radhachurra	Peltophorum Pterocarpum	100 x 125
127	Radhachurra	Peltophorum Pterocarpum	60 x 100
128	Radhachurra	Peltophorum Pterocarpum	0 x 100 Br-2
129	Radhachurra	Peltophorum Pterocarpum	120 x 90
130	Radhachurra	Peltophorum Pterocarpum	90 x 125
131	Radhachurra	Peltophorum Pterocarpum	90 x 100
132	Radhachurra	Peltophorum Pterocarpum	85 x 100
133	Radhachurra	Peltophorum Pterocarpum	105 x 125
134	Radhachurra	Peltophorum Pterocarpum	90 x 100
135	Radhachurra	Peltophorum Pterocarpum	90 x 100
136	Radhachurra	Peltophorum Pterocarpum	75 x 200
137	Radhachurra	Peltophorum Pterocarpum	40 x 60
138	Radhachurra	Peltophorum Pterocarpum	50 x 100
139	Radhachurra	Peltophorum Pterocarpum	110 x 125
140	Radhachurra	Peltophorum Pterocarpum	100 x 150 Br-2
141	Radhachurra	Peltophorum Pterocarpum	104 x 160
142	Radhachurra	Peltophorum Pterocarpum	80 x 80
143	Radhachurra	Peltophorum Pterocarpum	100 x 110
144	Radhachurra	Peltophorum Pterocarpum	90 x 100
145	Radhachurra	Peltophorum Pterocarpum	100 x 125
146	Radhachurra	Peltophorum Pterocarpum	60 x 60
147	Radhachurra	Peltophorum Pterocarpum	80 x 100
148	Radhachurra	Peltophorum Pterocarpum	110 x 100
149	Radhachurra	Peltophorum Pterocarpum	90 x 100
150	Radhachurra	Peltophorum Pterocarpum	45 x 80
151	Radhachurra	Peltophorum Pterocarpum	100 x 150
152	Radhachurra	Peltophorum Pterocarpum	105 x 125
153	Radhachurra	Peltophorum Pterocarpum	80 x 70
154	Radhachurra	Peltophorum Pterocarpum	85 x 125
155	Radhachurra	Peltophorum Pterocarpum	90 x 100
156	Radhachurra	Peltophorum Pterocarpum	110 x 150
157	Radhachurra	Peltophorum Pterocarpum	100 x 125
158	Radhachurra	Peltophorum Pterocarpum	100 x 70
159	Champa	Michelia Champaca	45 x 125
160	Champa	Michelia Champaca	70 x 250
161	Kathal	Artocarpus Heterophyllus	100 x 250
162	Kathal	Artocarpus Heterophyllus	55 x 125
163	Chalta	Dillenia Indica	95 x 400
164	Agar	Aquilaria Melacensis	145 x 1200
165	Radhachurra	Peltophorum Pterocarpum	100 x 150
166	Radhachurra	Peltophorum Pterocarpum	90 x 140
167	Radhachurra	Peltophorum Pterocarpum	90 x 100
168	Radhachurra	Peltophorum Pterocarpum	80 x 125
169	Radhachurra	Peltophorum Pterocarpum	70 x 125
170	Radhachurra	Peltophorum Pterocarpum	65 x 100
171	Radhachurra	Peltophorum Pterocarpum	45 x 90

172	Radhachurra	Peltophorum Pterocarpum	0 x 40
173	Radhachurra	Peltophorum Pterocarpum	90 x 50
174	Radhachurra	Peltophorum Pterocarpum	65 x 60
175	Radhachurra	Peltophorum Pterocarpum	45 x 50
176	Radhachurra	Peltophorum Pterocarpum	45 x 60
177	Radhachurra	Peltophorum Pterocarpum	85 x 150
178	Radhachurra	Peltophorum Pterocarpum	72 x 125
179	Radhachurra	Peltophorum Pterocarpum	100 x 80
180	Radhachurra	Peltophorum Pterocarpum	90 x 70
181	Bat	Ficus Religiosa	85 x 150
182	Arjun	Terminalia Arjuna	95 x 120
183	Krishnachurra	Delonix Regia	100 x 300
184	Sajna	Moringa Oleifera	82 x 200
185	Sajna	Moringa Oleifera	100 x 60

equipment taken
by me.

See Search. A. K. Gupta Fr.
D/O - S. D. N. H. Beat Office.
SAD 09.

Prasanna Debbarma, FR
Range Officer,
Sadar Forest Range.

Barjala Road Durga Chowmuhanl to Barjala Chowmuhanl

Sl No.	Species	Scientific name	Girth & height (in cm)
1	Bat	Ficus Religiosa	260 x 500 Br-6
2	Bat	Ficus Religiosa	0 x 350 Br-8
3	Kanchan	Bauhinia Purpurea	120 x 150
4	Nalocha	Trema Orientalis	30 x 60
5	Bat	Ficus Religiosa	125 x 60
6	Aam	Mangifera Indica	90 x 400
7	Aam	Mangifera Indica	30 x 60
8	Bel	Aegle Marmelous	110 x 250
9	Teak	Tectona Grandis	240 x 1200
10	Teak	Tectona Grandis	90 x 175
11	Raintree	Samania Saman	90 x 200
12	Aam	Mangifera Indica	60 x 90
13	Sajna	Moringa Oleifera	0 x 100 Br-2
14	Jam	Syzygium Cumini	80 x 200
15	Kathal	Artocarpus Heterophyllus	60 x 125
16	Bat	Ficus Religiosa	250 x 150 Br-4
17	Raintree	Samania Saman	150 x 350 Br-3
18	Raintree	Samania Saman	60 x 150
19	Raintree	Samania Saman	100 x 450
20	Sajna	Moringa Oleifera	80 x 175
21	Sajna	Moringa Oleifera	90 x 100
22	Sajna	Moringa Oleifera	60 x 150
23	Sajna	Moringa Oleifera	90 x 600
24	Bel	Aegle Marmelous	110 x 1000
25	Raintree	Samania Saman	80 x 300
26	Raintree	Samania Saman	120 x 90
27	Pongamia	Pongamia Pinnata	65 x 150
28	Kathal	Artocarpus Heterophyllus	250 x 800
29	Kathal	Artocarpus Heterophyllus	27 x 1200
30	Raintree	Samania Saman	105 x 150
31	Raintree	Samania Saman	180 x 150 Br-3
32	Debdaru	Polyalthia Longifolia	150 x 300
33	Kurcha	Holarrhena Antidysenterica	90 x 200
34	Kadam	Neolamarckia Cadamba	108 x 500
35	Mehagony	Swietenia Mahogoni	118 x 600
36	Bat	Ficus Religiosa	650 x 150 Br-6
37	Raintree	Samania Saman	390 x 150 Br-7
38	Mehagony	Swietenia Mahogoni	250 x 275 Br-2
39	Raintree	Samania Saman	130 x 300
40	Acacia	Acacia Auriculiformis	0 x 160 Br-2
41	Acacia	Acacia Auriculiformis	200 x 700 br-3
42	Raintree	Samania Saman	180 x 50 Br-2
43	Raintree	Samania Saman	100 x 150 Br-3
44	Raintree	Samania Saman	100 x 180
45	Raintree	Samania Saman	100 x 150
46	Debdaru	Polyalthia Longifolia	114 x 400
47	Debdaru	Polyalthia Longifolia	165 x 400 Br-3
48	Champa	Michelia Champaca	105 x 350
49	Raintree	Samania Saman	160 x 150
50	Raintree	Samania Saman	165 x 500
51	Raintree	Samania Saman	140 x 175
52	Raintree	Samania Saman	80 x 250
53	Pongamia	Pongamia Pinnata	95 x 100
54	Jam	Syzygium Cumini	90 x 250
55	Raintree	Samania Saman	195 x 250

56	Raintree	Samania Saman	140 x 175
57	Raintree	Samania Saman	120 x 160
58	Raintree	Samania Saman	160 x 400
59	Debdaru	Polyalthia Longifolia	180 x 150 Br-2
60	Debdaru	Polyalthia Longifolia	208 x 600 Br-2
61	Acacia	Acacia Auriculiformis	246 x 800 Br-2
62	Acacia	Acacia Auriculiformis	210 x 1200
63	Mehagony	Swietenia Mahogoni	180 x 600
64	Mehagony	Swietenia Mahogoni	120 x 100 Br-2
65	Sonal	Cassia Fistula	60 x 100
66	Kathal	Artocarpus Heterophyllus	60 x 150
67	Teak	Tectona Grandis	210 x 800
68	Mehagony	Swietenia Mahogoni	180 x 250 Br-4
69	Acacia	Acacia Auriculiformis	70 x 150
70	Sajna	Moringa Oleifera	60 x 60
71	Rangi	Chukrasia Tabularis	210 x 1200
72	Kathal	Artocarpus Heterophyllus	60 x 150
73	Kadam	Neolamarckia Cadamba	95 x 100
74	Raintree	Samania Saman	115 x 250
75	Raintree	Samania Saman	0 x 80 Br-2
76	Raintree	Samania Saman	169 x 175 Br-3
77	Raintree	Samania Saman	285 x 100 Br-3
78	Raintree	Samania Saman	0 x 124 br-2
79	Raintree	Samania Saman	229 x 1000
80	Raintree	Samania Saman	273 x 1000 Br-3
81	Raintree	Samania Saman	280 x 400 Br-2
82	Raintree	Samania Saman	380 x 200 Br-2
83	Bat	Ficus Religiosa	0 x 100 Br-2
84	Kaju	Anacardium Occidentale	120 x 1000
85	Kaju	Anacardium Occidentale	0 x 60 br-2
86	Kaju	Anacardium Occidentale	100 x 110
87	Jam	Syzygium Cumini	235 x 800 Br-3
88	Raintree	Samania Saman	220 x 1100
89	Raintree	Samania Saman	220 x 600
90	Raintree	Samania Saman	230 x 250 Br-3
91	Raintree	Samania Saman	280 x 400 Br-2
92	Raintree	Samania Saman	260 x 1100
93	Raintree	Samania Saman	270 x 400 Br-3
94	Raintree	Samania Saman	250 x 1200
95	Raintree	Samania Saman	305 x 800
96	Kadam	Neolamarckia Cadamba	155 x 600
97	Kadam	Neolamarckia Cadamba	150 x 700
98	Kadam	Neolamarckia Cadamba	150 x 800
99	Kadam	Neolamarckia Cadamba	160 x 710
100	Jarul	Lagerstroea specioser	60 x 200

Measurement
Taken by me

✓
Sri Swamin. Acharya P.
A/o- Hoshur Beat office.
Sadal.

Prasenjit Debbarma
Prasenjit Debbarma, FR
Range Officer,
Sadar Forest Range.

Jail Ashram Road Ashram Chowmuhani to Lalbahadur Junction

Sl No.	Species	Scientific name	Girth & height (In cm)
1	Debdaru	Polyalthia Longifolia	101 x 1000
2	Debdaru	Polyalthia Longifolia	91 x 1200
3	Debdaru	Polyalthia Longifolia	50 x 900
4	Debdaru	Polyalthia Longifolia	191 x 1300
5	Debdaru	Polyalthia Longifolia	88 x 900
6	Debdaru	Polyalthia Longifolia	70 x 700
7	Debdaru	Polyalthia Longifolia	73 x 600
8	Raintree	Samania Saman	38 x 600
9	Raintree	Samania Saman	37 x 900
10	Raintree	Samania Saman	46 x 800
11	Raintree	Samania Saman	47 x 600
12	Raintree	Samania Saman	58 x 1200
13	Raintree	Samania Saman	47 x 900
14	Raintree	Samania Saman	73 x 900
15	Raintree	Samania Saman	38 x 500
16	Raintree	Samania Saman	162 x 1000
17	Raintree	Samania Saman	173 x 900
18	Raintree	Samania Saman	255 x 800
19	Raintree	Samania Saman	117 x 800
20	Raintree	Samania Saman	156 x 700
21	Raintree	Samania Saman	220 x 900
22	Raintree	Samania Saman	68 x 700
23	Raintree	Samania Saman	88 x 700
24	Raintree	Samania Saman	90 x 1000
25	Raintree	Samania Saman	90 x 900
26	Raintree	Samania Saman	107 x 800
27	Raintree	Samania Saman	220 x 900
28	Raintree	Samania Saman	217 x 800
29	Chatim	Aistonia Scholaris	153 x 900
30	Chatim	Aistonia Scholaris	97 x 700
31	Chatim	Aistonia Scholaris	73 x 600
32	Chatim	Aistonia Scholaris	800 x 700
33	Chatim	Aistonia Scholaris	163 x 900
34	Chatim	Aistonia Scholaris	130 x 700
35	Chatim	Aistonia Scholaris	140 x 600
36	Chatim	Aistonia Scholaris	94 x 600
37	Neem	Azadirachta Indica	81 x 600
38	Bat	Ficus Religiosa	400 x 600
39	Bat	Ficus Religiosa	400 x 900
40	Bat	Ficus Religiosa	143 x 900
41	Bat	Ficus Religiosa	300 x 700
42	Pongamia	Pongamia Pinnata	40 x 400
43	Barai	Zizyphus Jujuba	69 x 600
44	Pongamia	Pongamia Pinnata	118 x 700
45	Pongamia	Pongamia Pinnata	140 x 900
46	Neem	Azadirachta Indica	82 x 700
47	Champa	Michelia Champaca	61 x 700

Measurement
taken by me.

Sri Sankar Acharya
A/o- Howrah Beat Office.
30/04/11

Place: Howrah, FR
Date: 29/04/11

Mantri Bari Road Post Office Chowmuhani to RMS Chowmuhani

Sl No.	Species	Scientific name	Girth & height (in cm)
1	Pongamia	Pongamia Pinnata	91 x 700
2	Champa	Michelia Champaca	80 x 700

Road surrounding the proposed IT Hub site Jail Ashram Road to B.T Road

Sl No.	Species	Scientific name	Girth & height (in cm)
1	Champa	Michelia Champaca	40 x 150
2	Barai	Zizyphus Jujuba	70 x 300
3	Bakul	Mimusops Elengi	48 x 250
4	Arjun	Terminalia Arjuna	65 x 200
5	Arjun	Terminalia Arjuna	120 x 300
6	Arjun	Terminalia Arjuna	55 x 150
7	Arjun	Terminalia Arjuna	60 x 160
8	Sajna	Moringa Oleifera	120 x 300
9	Neem	Azadirachta Indica	45 x 150
10	Neem	Azadirachta Indica	40 x 140
11	Neem	Azadirachta Indica	40 x 150
12	Chalta	Dillenia Indica	50 x 150
13	Raintree	Samanea Saman	40 x 150
14	Acacia	Acacia Auriculiformis	90 x 300
15	Acacia	Acacia Auriculiformis	40 x 150
16	Krishnachurra	Delonix Regia	320 x 600 Br-2
17	Bat	Ficus Religiosa	275 x 600 Br-8
18	Rudrakha	Elaeocarpus Ganitrus	105 x 400

Ronaldsay Road Durga Chowmuhani to Ker Chowmuhani/Fire Bridged Chowmuhani

Sl No.	Species	Scientific name	Girth & height (in cm)
1	Debdaru	Polyalthia Longifolia	95 x 300
2	Neem	Azadirachta Indica	48 x 300
3	Neem	Azadirachta Indica	36 x 200
4	Chatim	Alstonia Scholaris	100 x 700
5	Chatim	Alstonia Scholaris	71 x 600
6	Chatim	Alstonia Scholaris	38 x 700
7	Neem	Azadirachta Indica	96 x 600
8	Tetul	Tamarindus Indica	91 x 600
9	Xmas tree	Araucaria Heterophylla	45 x 600

GB Road GB Chakra to Ramthakur Club Chowmuhani

Sl No.	Species	Scientific name	Girth & height (in cm)
1	Bat	Ficus Religiosa	120 x 400
2	Bat	Ficus Religiosa	90 x 500
3	Bat	Ficus Religiosa	150 x 200
4	Bat	Ficus Religiosa	125 x 300
5	Bat	Ficus Religiosa	212 x 600 Br-2
6	Krishnachurra	Delonix Regia	168 x 200 Br-2
7	Krishnachurra	Delonix Regia	66 x 150
8	Krishnachurra	Delonix Regia	122 x 600
9	Krishnachurra	Delonix Regia	53 x 300
10	Bakul	Mimusops Elengi	100 x 700
11	Bakul	Mimusops Elengi	70 x 800
12	Bakul	Mimusops Elengi	46 x 150
13	Bakul	Mimusops Elengi	83 x 700
14	Bakul	Mimusops Elengi	52 x 400
15	Bakul	Mimusops Elengi	78 x 200
16	Champa	Michelia Champaca	46 x 200
17	Champa	Michelia Champaca	73 x 300
18	Debdaru	Polalthia Longifolia	108 x 600
19	Debdaru	Polalthia Longifolia	35 x 300
20	Debdaru	Polalthia Longifolia	123 x 600
21	Neem	Azadirachta Indica	67 x 400
22	Neem	Azadirachta Indica	45 x 300
23	Neem	Azadirachta Indica	145 x 700
24	Neem	Azadirachta Indica	120 x 700
25	Kathal	Artocarpus Heterophyllus	164 x 700
26	Kathal	Artocarpus Heterophyllus	125 x 600
27	Kathal	Artocarpus Heterophyllus	125 x 700
28	Kathal	Artocarpus Heterophyllus	135 x 500
29	Kathal	Artocarpus Heterophyllus	80 x 300
30	Kathal	Artocarpus Heterophyllus	135 x 600
31	Kathal	Artocarpus Heterophyllus	0 x 600 Br-3
32	Aam	Mangifera Indica	238 x 1000 Br-2
33	Aam	Mangifera Indica	75 x 700
34	Jarul	Lagerstroea specioser	123 x 400
35	Jarul	Lagerstroea specioser	100 x 200
36	Jarul	Lagerstroea specioser	63 x 400
37	Jarul	Lagerstroea specioser	90 x 100
38	Jarul	Lagerstroea specioser	95 x 200
39	Jarul	Lagerstroea specioser	105 x 100
40	Jarul	Lagerstroea specioser	110 x 800
41	Jarul	Lagerstroea specioser	115 x 900
42	Bel	Aegle Marmelous	100 x 400
43	Tula	Bombax Ceiba	212 x 700 Br-2
44	Sonal	Cassia Fistula	65 x 400
45	Sonal	Cassia Fistula	45 x 200
46	Sonal	Cassia Fistula	145 x 300
47	Rangi	Chukrasia Tabularis	135 x 600

Me Surendra Jha by M.

Sri Sachin Acharya pr.
A/c Boudh Bara 07-11-11
SADAN.

Prasenjit Debbarma, FR
Range Officer,
Sadar Forest Range.

Thakurpalli Road Ker Chowmuhani to Purbasa Chowmuhani

Sl No.	Species	Scientific name	Girth & height (in cm)
1	Debdaru	Polyalthia Longifolia	60 x 600
2	Debdaru	Polyalthia Longifolia	75 x 100 Br-2
3	Debdaru	Polyalthia Longifolia	120 x 150
4	Debdaru	Polyalthia Longifolia	95 x 150
5	Debdaru	Polyalthia Longifolia	55 x 150
6	Debdaru	Polyalthia Longifolia	80 x 150
7	Debdaru	Polyalthia Longifolia	40 x 80
8	Debdaru	Polyalthia Longifolia	70 x 200
9	Necm	Azadirachta Indica	75 x 150
10	Acacia	Acacia Auriculiformis	120 x 600
11	Mahogany	Swietenia Mahogoni	60 x 200
12	Udai	Sterculia Billosa	40 x 100
13	Chalta	Dillenia Indica	40 x 100
14	Raintree	Samania Saman	100 x 400
15	Raintree	Samania Saman	40 x 100
16	Raintree	Samania Saman	125 x 600
17	Raintree	Samania Saman	0 x 325 Br-3
18	Krishnachurra	Delonix Regia	90 x 200
19	Krishnachurra	Delonix Regia	60 x 120
20	Krishnachurra	Delonix Regia	40 x 90
21	Krishnachurra	Delonix Regia	40 x 50
22	Krishnachurra	Delonix Regia	60 x 170 Br-2
23	Debdaru	Polyalthia Longifolia	120 x 450
24	Debdaru	Polyalthia Longifolia	60 x 200
25	Pongamia	Pongamia Pinnata	40 x 80
26	Palash	Butea Monosperma	50 x 80
27	Arjun	Terminalia Arjuna	90 x 600

Measurement taken by Mr.

[Signature]
 Forest Officer,
 Sadar Forest Range.

*Dr. Sankar. Akharya
 Ajo-Hood Sak
 Sadar.*

Akhura Road Fire Briged Chowmuhani to Jackson Gate Chowmuhani

Sl No.	Species	Scientific name	Girth & height (in cm)
1	Raintree	Samania Saman	275 x 600 Br-3
2	Raintree	Samania Saman	175 x 100 Br-2
3	Raintree	Samania Saman	225 x 100 Br-3
4	Raintree	Samania Saman	75 x 700
5	Neem	Azadurachta Indica	40 x 300
6	Neem	Azadurachta Indica	35 x 400
7	Neem	Azadurachta Indica	45 x 300
8	Bakul	Mimusops Elengi	65 x 500
9	Champa	Michelia Champaca	65 x 600

Hariganga Basak Road Battala Chowmuhani to Ashram Chowmuhani

Sl No.	Species	Scientific name	Girth & height (in cm)
1	Champa	Michelia Champaca	35 x 300
2	Champa	Michelia Champaca	45 x 400
3	Debdaru	Polyalthia Longifolia	39 x 300
4	Debdaru	Polyalthia Longifolia	60 x 600
5	Raintree	Samania Saman	260 x 100 Br-4
6	Raintree	Samania Saman	260 x 100 Br-2
7	Raintree	Samania Saman	217 x 300 Br-2
8	Raintree	Samania Saman	270 x 100 Br-3
9	Raintree	Samania Saman	210 x 100 br-5
10	Raintree	Samania Saman	170 x 200 br-2
11	Raintree	Samania Saman	210 x 600
12	Raintree	Samania Saman	170 x 900
13	Raintree	Samania Saman	175 x 100 Br-2
14	Raintree	Samania Saman	220 x 100 Br-4
15	Raintree	Samania Saman	195 x 100 Br-2
16	Raintree	Samania Saman	270 x 100 Br-3
17	Raintree	Samania Saman	270 x 100 Br-3
18	Raintree	Samania Saman	0 x 600 Br-2
19	Raintree	Samania Saman	165 x 700
20	Raintree	Samania Saman	130 x 600
21	Raintree	Samania Saman	127 x 700
22	Krishnachurra	Delonix Regia	210 x 1200
23	Radhachurra	Peltaphorum Pterocarpum	240 x 1000
24	Radhachurra	Peltaphorum Pterocarpum	45 x 600
25	Bakul	Mimusops Elengi	75 x 800
26	Bakul	Mimusops Elengi	45 x 300
27	Bat	Ficus Religiosa	210 x 100

Measurement taken by me.

Prasenjit Das, FR
Range Officer,
Sadar Forest Range.

Sri Sukhdev Acharya
A/c. Houshal Dist Office -
Bardhaman

Math Chowmuhani to old Jail Road

Sl No.	Species	Scientific name	Girth & height (in cm)
1	Raintree	Samania Saman	135 x 600
2	Xmas tree	Araucaria Heterophylla	45 x 400

 Prasanna Debbama, FR
 Range Officer,
 Sadar Forest Range.

Measurements taken by me.

Sri Sankar, Acharjya
 A/O - Honorary Asst Officer
 Sadar.

Appendix 16: Forest Department Letter on Tree Cutting and Compensatory Plantation Cost

No.F.11-13/WFD/Deptt.Oprnt/2018-19/ //595-597
Government of Tripura
Office of the District Forest Officer
West Tripura, Agartala

Dated 27/01/2020

To
The chief executive officer
Agartala Smart City Ltd
UD Bhavan, Agartala

Sub: - request for providing details on compensatory plantation and provisional cost for felling of trees along designated urban roads regarding.
Ref: - No F.4(34)/ASCL/2018/917 dated 19/02/2020

Sir,

With reference to subject cited above, the tentative preliminary estimate for extraction of trees would be 3696000 (thirty six lakh ninty thousand only) as submitted by sdfo sadar.(copy enclosed).

The compensatory plantation must be raised twice the amount of tree felled so in this case minimum one hectare artificial regeneration plantation must be raised the suitable land for which may be identified at nearby degraded forest land at later stage .The cost of raising one hectare plantation will be 324662(three lakh twenty four thousand six hundred and sixty six only) as per government of Tripura notification vide noF.6-273/FC/For-2004/Pt-I/2599-627 dated 24/09/2019 (copy enclosed)

This is for favour of your kind information and doing the need full

Yours faithfully,

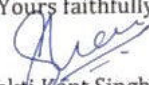
(Shakti Kant Singh, IFS)
District Forest Officer
West Tripura District

Copy to:

1. SDFO Sadar for information and necessary action
2. Range officer Sadar for information and necessary action

27/02
District Forest Officer
West Tripura District

Government of Tripura
Forest Department

1. **Name of the Scheme:-** Compensatory Afforestation Scheme

2. **Brief Description:-** The Scheme has been drawn up for raising compensatory plantation in the degraded forest land by raising plantation e.g. MiSc. Species/ Poly bag planting etc. As per approved specification

3. **Wages Rate:-** Rs. 192/- (Rupees one hundred ninety-two only) per day as per memo No.F.2(5-35)-PE/PR/2017/10567-708 dated 16.07.2019 of Adl. Secretary, Govt. of Tripura, RDPanchayat) Department and approved by Govt. in Forest Dept. Vide U.O. No.-450/MIN/For/2019 dt. 03.09.2019

4. Provision is also kept for anticipatory increase of wages & materials for subsequent year

1 st Year Plantation			
Sl. No.	Item of Works	No. DL/ha	Amount (in Rs.)
1	Survey by using GPS instrument, clearing of the periphery, fixing of permanent/ durable pegs to be retained at least one year. Pegs should be numbered serially. Track polygon (raw data) is to be submitted within 5 (five) days after completion of survey.	3	576
2	Jungle cleaning including disposal of debris	20	3840
3	Stacking at spacing of as per model requirement with sticks of 1m long including collection of sticks etc complete & digging of pits of 45 cm x 45 CM x 45 CM size for 190 nos bamboo at 4.5m x 4.5m spacing and of 30 cm x 30 cm x 30 cm size for 750 nos Acacia mangium at 2m x 2m spacing	50	9600
4	Re-filling of pits after removal of foreign materials, breaking of clods and planting of stumps/ rhizome/ seedling after removal of seedling pot, including pitting with crowbar for teak and carrying of stumps/ seedlings up to plantation site etc.	76	14592
5	Providing fencing, L.S	per ha	70000
6	First weeding including base cleaning in thall at a radius of 0.5 m by scraping with spade and cutting of weeds in between the lines flush to the ground level including vacancy filling with required plant spp including digging of pits, refilling & planting including carrying of seedlings. Teak will be replaced by Acacia mangium in case of mortality	25	4800

DISTRICT O. WEST TRIPURA

RECEIVED

3070

3070

29/9/19

7	Second Weeding including cleaning of base in thali at a radius of 0.5m by scraping with spade and cutting of weeds in between the lines flush to the ground level	18	3456
8	Vacancy filling (10%)	5	960
9	radius of 0.5 m by scurping & cutting weeds in between the lines flush the ground including making of fire line 4m wide & diagonal inspection path 1 m	18	3456
10	Fire line & inspection path diagonally through out the plantation area and making road for inspection	10	1920
11	Cost of Planting materials including transportation	-	50000
12	Cost of sign board etc. L.S.	-	5000
13	Engagement of a watch and wards throughout the year responsible for maintenance of fencing, cattle watching etc. (responsibility will be entrusted to JFMC/EDC members). (Payment to be made in 3(three) installment 20% 1 st installment, 20 % second installment and 60 % & 3 rd installment depending on satisfactory performance	1	25920
Total			194120
<i>Provision of 15 % anticipatory increase of wages & materials</i>			<i>29118</i>
Sub-Total			223238
2nd Year Maintenance			
Sl. No.	Item of Works	No. DLs/ha	Amount (in Rs.)
1	First weeding including base cleaning in thali at a radius of 0.5 m by scraping with spade and cutting of weeds in between the lines flush to the ground level including vacancy filling with required plat spp including digging of pits, refilling & planting including carrying of seedlings. Teak will be replaced by Acacia mangium in case of mortality	24	4608
2	Second Weeding including cleaning of base in thali at a radius of 0.5m by scraping with spade and cutting of weeds in between the lines flush to the ground level	18	3456
3	Vacancy filling (20%)	6	1152
4	Maintenance of fencing L.S	per ha	8000
5	Cost of Planting materials including transportation	-	8000
6	Fire lines & inspection path	10	1920

7	Winter cleaning including cleaning of base in thali at a radius of 0.5 m by scarping & cutting weeds in between the lines flush the ground including making of fire line 4m wide & diagonal inspection path 1 m wide by scraping spade and maintenance of the same throughout the dry season	18	3456
Total			30582
<i>Provision of 20 % anticipatory increase of wages & materials</i>			6118.4
Sub-Total			36710.4
3rd Year Maintenance			
Sl. No.	Item of Works	No. DLs/ha	Amount (in Rs.)
1	First weeding including base cleaning in thali at a radius of 0.5 m by scraping with spade and cutting of weeds in between the lines flush to the ground level including vacancy filling with required plat spp including digging of pits, refilling & planting including carrying of seedlings. Teak will be replaced by <i>Acacia mangium</i> in case of mortality	13	2496
2	Second Weeding including cleaning of base in thali at a radius of 0.5m by scraping with spade and cutting of weeds in between the lines flush to the ground level	10	1920
3	Winter cleaning including cleaning of base in thali at a radius of 0.5 m by scarping & cutting weeds in between the lines flush the ground including making of fire line 4m wide & diagonal inspection path 1 m wide by scraping spade and maintenance of the same throughout the dry season	13	2496
4	Fire lines & Inspection path	5	960
5	Maintenance of fencing L.S	-	8000
Total			15872
<i>Provision of 25 % anticipatory increase of wages & materials</i>			3968
Sub-Total			19840
4th Year Maintenance			
Sl. No.	Item of Works	No. DLs/ha	Amount (in Rs.)
1	First weeding including base cleaning in thali at a radius of 0.5 m by scraping with spade and cutting of weeds in between the lines flush to the ground level including vacancy filling with required plat spp including digging of pits, refilling & planting including carrying of seedlings. Teak will be replaced by <i>Acacia mangium</i> in case of mortality	13	2496

	Second Weeding including cleaning of base in thall at a radius of 0.5m by scraping with spade and cutting of weeds in between the lines flush to the ground level	18	1456
3	Fire lines & Inspection path	5	960
4	Maintenance of fencing L.S	-	8000
Total			14912
<i>Provision of 30 % anticipatory increase of wages & materials</i>			<i>4473.6</i>
Sub-Total			19385.6
4th Year Maintenance			
Sl. No.	Item of Works	No. DLs/ha	Amount (in Rs.)
1	Cultural operation	15	2880
<i>Provision of 35 % anticipatory increase of wages & materials</i>			<i>1008</i>
Total			3888
5th Year Maintenance			
Sl. No.	Item of Works	No. DLs/ha	Amount (in Rs.)
1	Cultural operation	15	2880
<i>Provision of 40 % anticipatory increase of wages & materials</i>			<i>1152</i>
Total			4032
6th Year Maintenance			
Sl. No.	Item of Works	No. DLs/ha	Amount (in Rs.)
1	Cultural operation	15	2880
<i>Provision of 45 % anticipatory increase of wages & materials</i>			<i>1296</i>
Total			4176
7th Year Maintenance			
Sl. No.	Item of Works	No. DLs/ha	Amount (in Rs.)
1	Cultural operation	15	2880
<i>Provision of 50 % anticipatory increase of wages & materials</i>			<i>1440</i>
Total			4320
8th Year Maintenance			
Sl. No.	Item of Works	No. DLs/ha	Amount (in Rs.)
1	Cultural operation	15	2880
<i>Provision of 55 % anticipatory increase of wages & materials</i>			<i>1584</i>
Total			4464

Year Maintenance			
Sr. No.	Item of Works	No. DLs/ha	Amount (in Rs.)
1	Cultural operation	15	2880
Provision of 60 % anticipatory increase of wages & materials			1728
Total			4608
Grand Total :-			324662

(Rupees three lakhs, twenty four thousand, six hundred and sixty-two only)
The rates are for raising 1 ha plantation. The cost will be charged as per actual stipulation regarding Compensatory Afforestation/ Penal Compensatory Afforestation.

(Harshakumar C)
Joint Secretary
to the Government of Tripura

No.F.6-273/FC/Fur-2004/P1-I/25509-627
GOVERNMENT OF TRIPURA
OFFICE OF THE PRINCIPAL CHIEF CONSERVATOR OF FORESTS
TRIPURA: AGARTALA

Dated, Agartala, the 24 / 09 / 2019

Copy to:-

1. The District Forest Officer, North / South / West / Dhalai/ Sepahijala/Gomati/Khowai/mao etc
2. The Sub-Divisional Forest Officer, Dharmnagar/ Kanchanpur/ Kailashahar/ Kamarghat/ Manu/Ambassa/ Teliamum/ Khowai/ Sadar /Mandai/ Bishalgarh/ Sonamun/ Udaipur/ Amarapur/ Karbook/ Bagufa/ Sabrum
3. The Wild Life Warden, Sepahijala / Trishna/ Rowa/ Gumti



20-09-19
Joint Secretary
to the Government of Tripura

Appendix 18: Strip Plan of Smart Roads

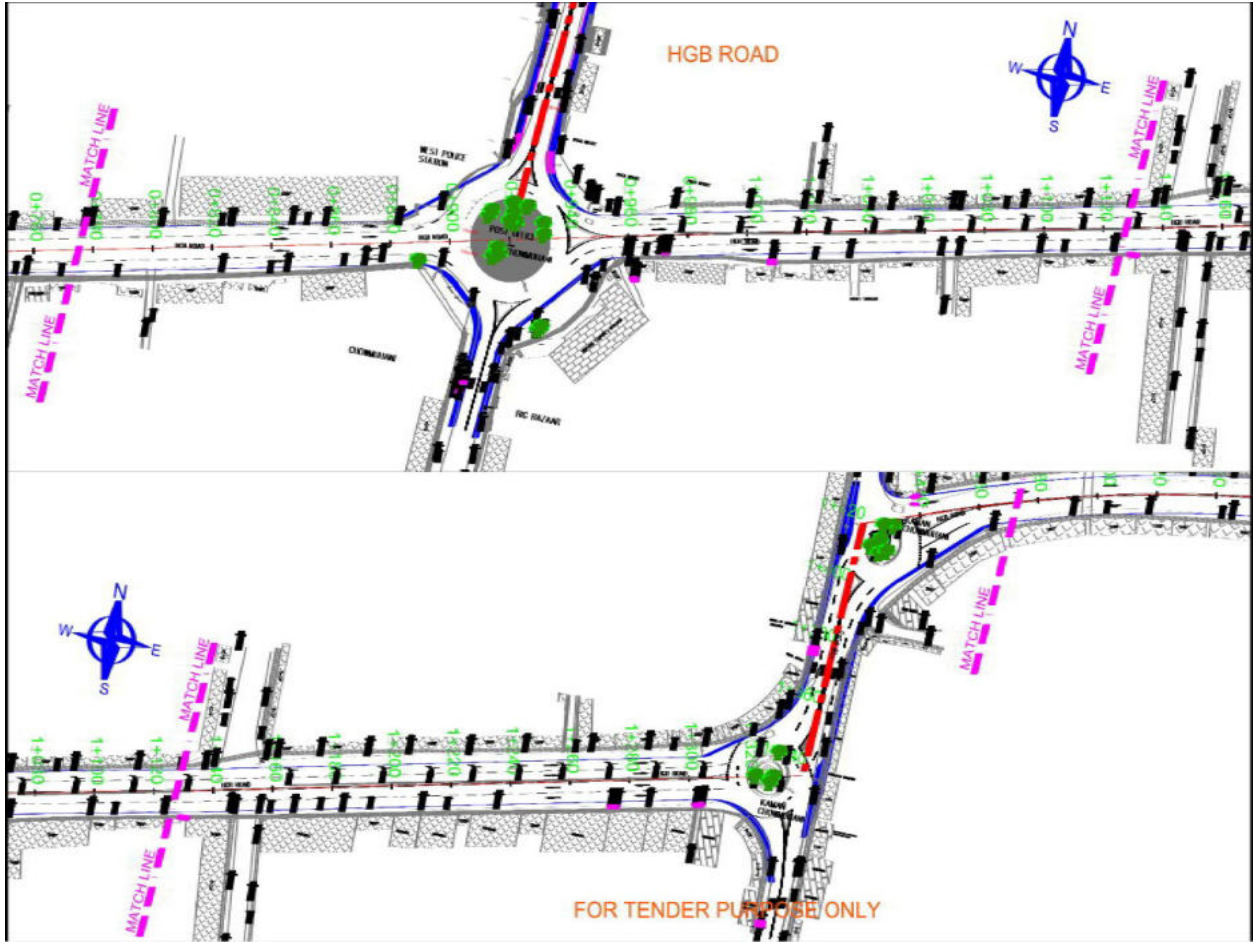



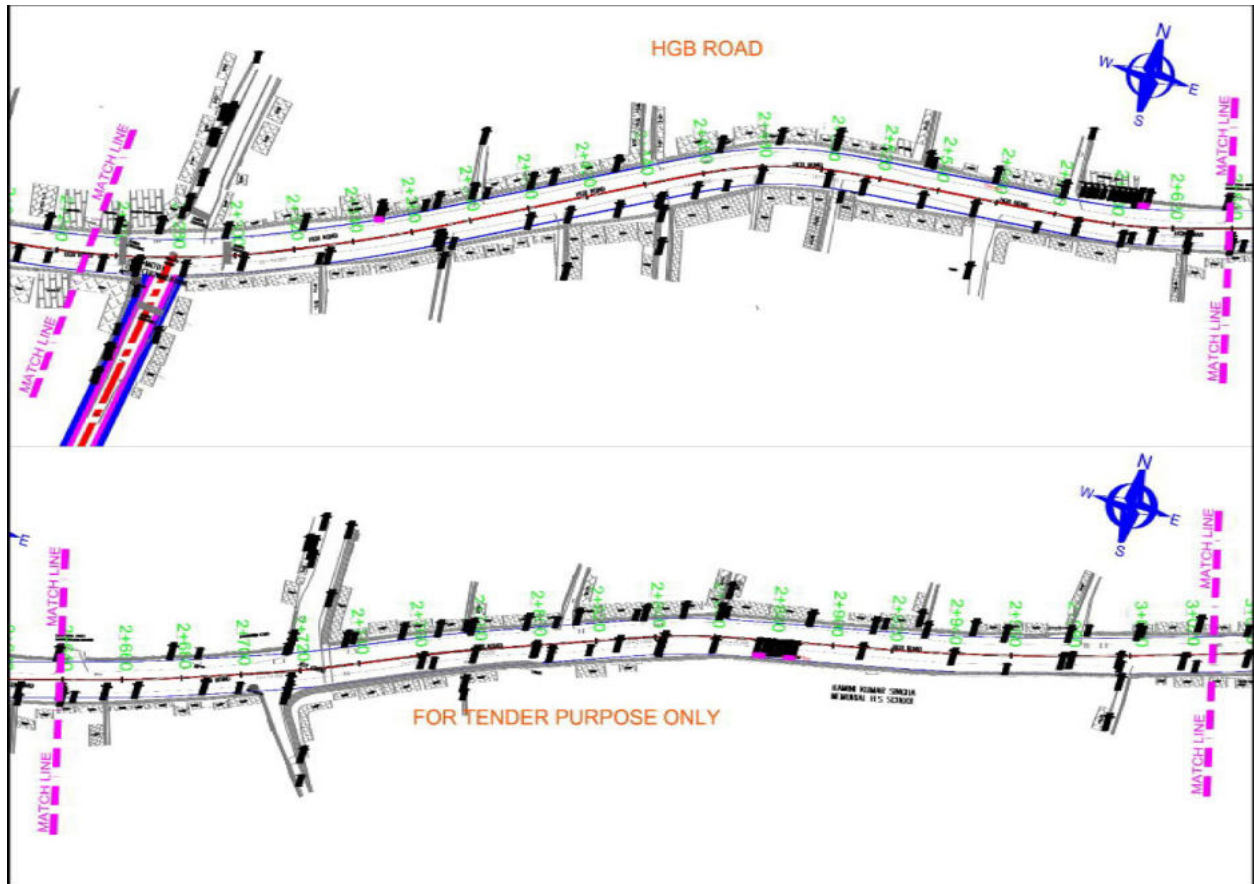



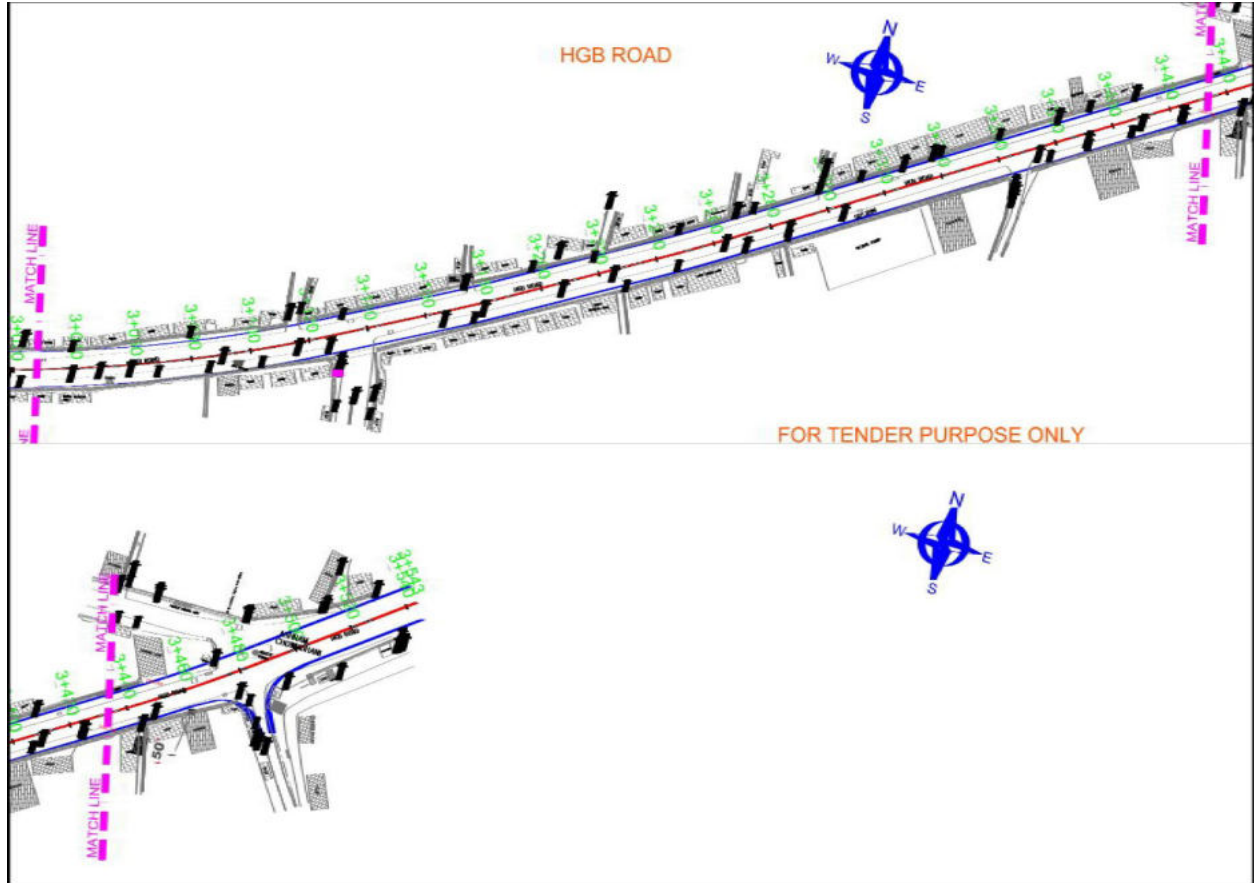



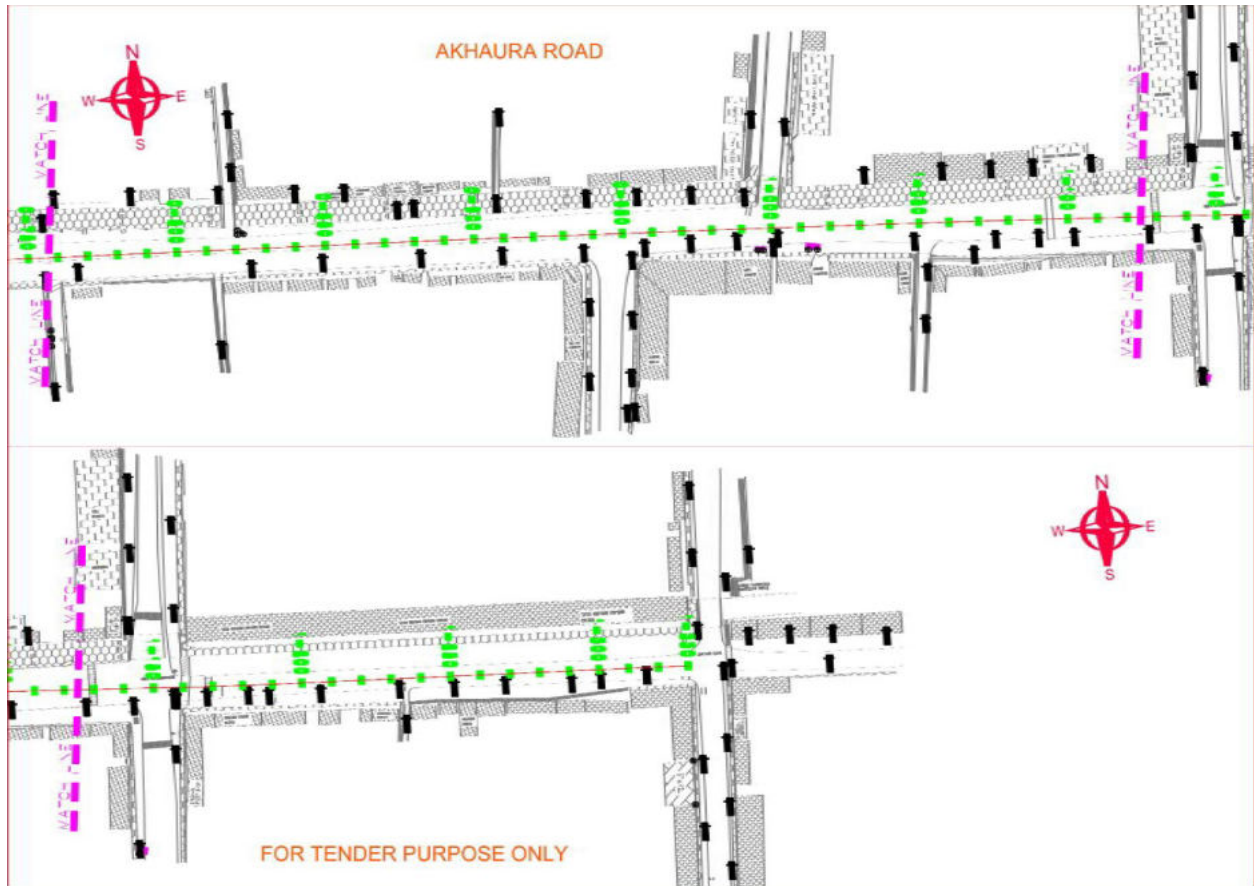

MANTRIBARI ROAD

